

**Full Automatic Washing Machine**

**User's manual**

# Haier

This manual is for  
**HWM60-20B**

- Please read this manual carefully before using.
- Retain it for future reference.

The Haier logo, consisting of the word "Haier" in a white, sans-serif font, centered within a dark gray square.

**Haier**

0030507862

# Contents

Specifications.....the 2 <sup>nd</sup> cover	
Names of the parts.....	1
Safety precautions .....	2
Installation and adjustment .....	4
Preparation before washing .....	8
Put in the laundries .....	9
Usage of the detergent .....	9
Use the operation buttons .....	10
Close the top lid .....	13
Finish washing .....	13
Disposal after washing .....	14
Trouble shooting • Answer to question.....	15
Packing list .....	16

## Specification

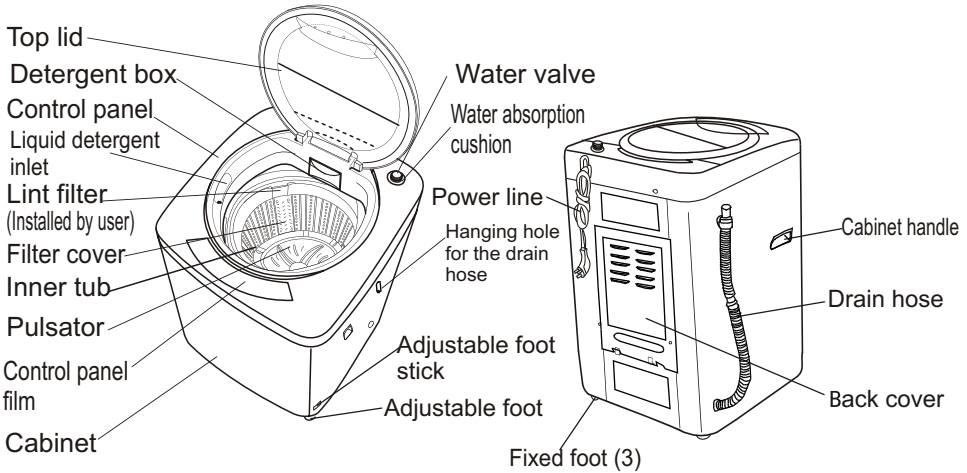

Water level/Water quantity (about)	1/15L、2/18L、3/23L、4/26L、5/28L、6/31L、7/33L、8/35L、9/38L、10/42L
Water inlet pressure (MPa)	0.03-0.78
Rated washing / spinning capacity (kg)	6.0/6.0

# Names of the parts



Notes: All illustrations in this Manual are given for reference only. Your products and accessories may show differences from these illustrations due to our continuous improvement.

## Meaning and description of the symbols

<p>Warning sign</p> 	<p>Contents marked with that symbol are related to the safety of the product and the personal safety of the users. Please operate in strict conformity to the contents, otherwise it may cause damage of the machine or injure the personal safety of the user.</p>
<p>Forbidden sign</p> 	<p>Contents marked with that symbol are actions forbidden to perform. Performing of those actions may result in damage of the machine or injure the personal safety of the user.</p>

- Please check if the power receptacle has good earthing condition before using to guarantee your safety.

## Safety precautions

Please plug the plug on special receptacle with rated voltage. Be sure to use single-phase three pins receptacle. Ensure the earthing prong of the power receptacle is earthed reliably. Use leakage protector if possible.



The power cord plug should be convenient to be plugged in or plugged out with hand while the washing machine runs normally. Be sure to pull the plug out and close the water tap when the machine is idle, when moving the machine, or when cleaning the machine. Do not use wet hand to insert or pull out the power plug.



Do not damage the power cord, bend, extend, twist, bind or alter it by force. Do not press or nip it with weight. If the power cord or the power plug is bad, or the power plug becomes flexible, to avoid risk it is required to have it replaced by the technicians of our special shop or the after-sale service department. Keep the pin of the power plug clean, if the power plug is polluted with dust, please wipe with dry cloth carefully.



In case the washing machine is installed on ground with carpet, do not block the ventilation hole with carpet.

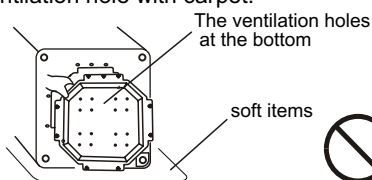

Do not use water hotter above 50°C.



Do not put the machine at damp place like the bathroom. Never wash it with water. Not put wet laundries on the control panel.

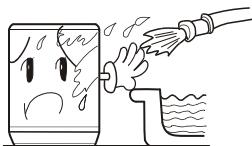

Do not wash water-proof laundries like the raincoat, bike covers etc. to avoid abnormal vibrations in spinning.



Do not let the machine share one receptacle with other electric appliances. If the power plug is damaged, or the plugging into the receptacle is loose, do not use the plug any more.

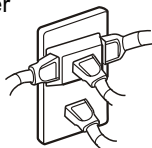

# Safety precautions

Do not stretch hands into the working machine. It is dangerous even if the rotation is slow. Take special care of the children. Do not let the children climb the washing machine.



Do not decompose, repair or alter the machine by yourself.



Do not put any hot or heavy items (such as the kettle with hot water) on the washing machine.



Do not wash laundries with volatile materials (such as thinner, petrol etc.)



The handicapped or children without care shall not use the machine.

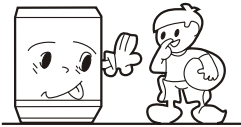

Keep the machine away from direct sunlight and heat source like the heater.

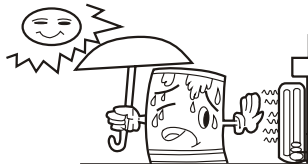

To prevent the lint inside the tub from blocking the cascade outlet during washing, please keep the lint filter in good condition, and install it to proper position. If the lint filter is lost or damaged, please contact the local after-sales service department of our company.



- To protect your laundries and washing machine, please take out all of the coins, buttons, sand, hairpin and other foreign materials before washing.



- Please check if the water faucet is open, and if the connection of the water inlet pipe is proper.
- It is suggested to use foamless washing powder.

# Installation and adjustment

Please install and adjust the machine according to the requirement of the manual. It is very important to your security and correct operating the machine.

## Install the lint filter

Push the lint filter downward to location for lint filter.

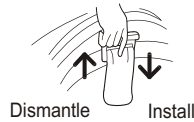

## Install the bottom plate

After you open the package, please lean the washing machine gently down on soft items ( like the towel cloth, blanket, etc. ). Install the bottom plate to the bottom of the machine with the eight screws by a cross screwdriver, then lift the machine up gently. See to the figure:

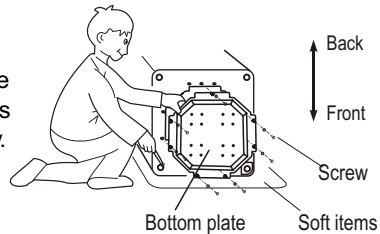

## Adjust the installation position

The largest allowed slope of the shank base of the machine is  $2^\circ$ . The slanting or rough ground will result in unstable running or stoppage of the machine. Please adjust it with following methods:

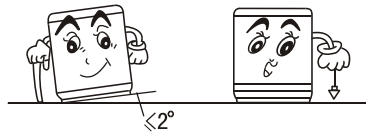

### ● Adjust the adjustable foot:

- 1.To twist the adjustable foot, please first lift up the side of the foot slightly, loosen the adjustable nut, and twist the foot.
- 2.Fasten the nut after adjustment.

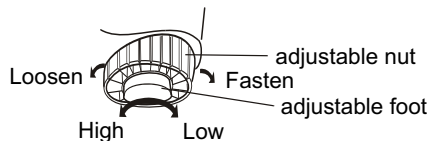

# How to change the direction of the drain hose

1. Dismantle the back cover of the washing machine.
2. Put down the drain hose. Take off the drain hose frame. As indicated in Figure 1, put the drain hose into the cabinet. Then stretch one hand into the cabinet to nip the claw of the drain hose bushing to remove the claw from original position. Take off the drain hose bushing with the other hand. (As indicated in Figure 2 and 3).

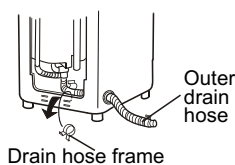

Figure 1

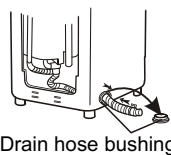

Figure 2

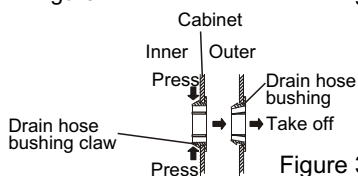

Figure 3

3. Dismantle the protecting cover of the drain outlet at the other side (method the same as the bushing). Install the bushing as per indicated in Figure 4.

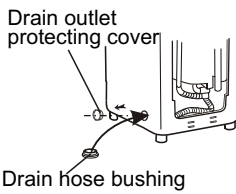

Figure 4

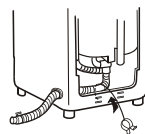

Figure 5

4. Extend the drain hose from the other side. Fix the drain hose onto the base frame with the drain hose frame. (As indicated in Figure 5)
5. Install the protecting cover of the drain outlet at the other side as per indicated in Figure 6.

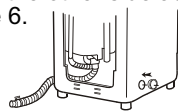
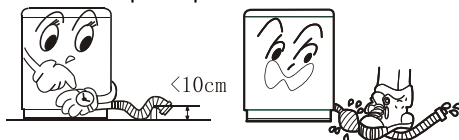

Figure 6

## Usage of the drain hose

The drain hose shall drain smoothly

1. The height of the drain hose shall be less than 10cm, or the drainage will not be smooth, and cost such long time that the machine may stop at mid way.
2. Do not trample or press the drain hose.



3. If the drain hose is too long, cut it at mid point. To make smooth drainage, cut the front end of the hose slantingly.

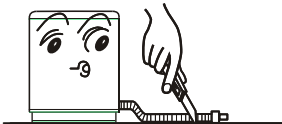

4. If extra drain hose is needed, please make separate purchase. The inner diameter of the extra hose shall not less than 30mm, and the length shall not exceed 1.5m.

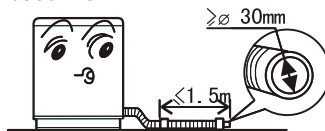

- If the extra hose is too long, cut it either at A or at B point.

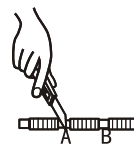

## Install the water inlet hose

### Confirm the water tap

Water tap, suitable



Water tap, not suitable

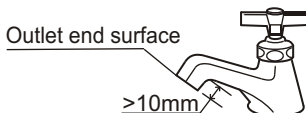
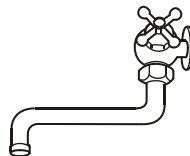

It is required that the frontend shall be longer than 10mm.

The outlet end surface of the tap shall be flat and smooth. If not please file it to avoid leakage.

### Connection between the water inlet hose jointer and the water tap

1. Use the new water inlet hose provided with the machine to connect to the water faucet. Old hose sets should not be reused.
2. Press the lower end of the lock lever and push down the slider. Take off the water inlet hose jointer from the water inlet hose component. See to Figure 1.
3. Loosen the screw till the water tap can be accessed. Put the jointer of the water inlet hose on the tap. See to Figure 2. (If the tap diameter is too large and the jointer can not be set on the water tap, please loosen the four screws and take out the bushing in the jointer. See to the figure3.)

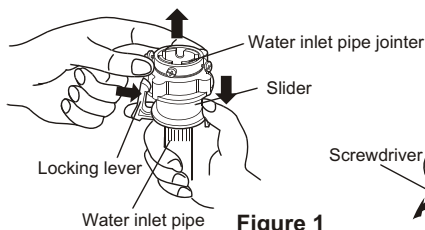

Figure 1

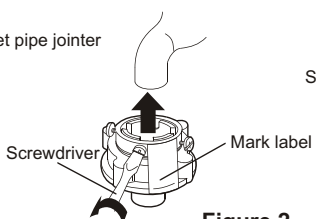

Figure 2

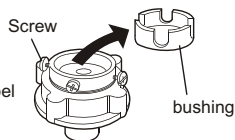

Figure 3

4. Fasten the four screws evenly. See to Figure 4.

5. Take off the nameplate. Twist the fastening nut as per the indication of the figure. See to Figure 5.

Remarks: Before twisting the fastening nut, the thread is 4mm above the upper surface of the nut. After twisting the fastening nut, the thread is 2mm above the upper surface of the nut. See to Figure 6.

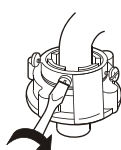

Figure 4

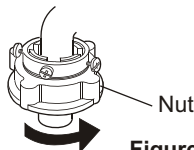

Figure 5

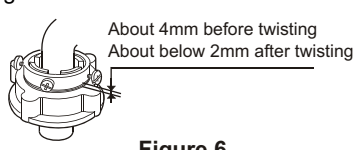
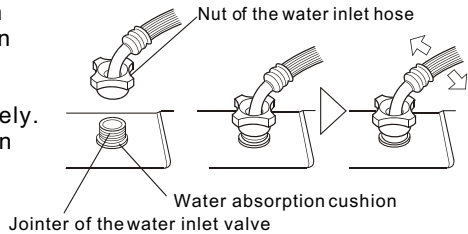

Figure 6



## Connection between the water inlet hose and the washing machine

1. Do not take off the water absorption cushion. Please check if the cushion is dropped or damaged before each usage. If it happens please contact our after-sale department immediately.
2. Put the nut of the water inlet hose on the valve jointer.
3. Fasten the nut. Swaying it gently to confirm if it's suitable.



## Connection between the jointer of the water inlet hose and the water inlet hose

1. Push down the slider. Insert the water inlet hose into the jointer.
2. Hang the lock lever to the jointer. Release the slider till a click sound is heard.

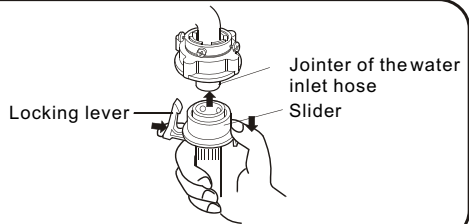

## Check the connection between the jointer of the water inlet hose and the water tap

1. Swaying the hose gently to confirm if it is fastened stable.
2. After installation, open the tap to check if it leaks.
3. Do not bend the hose with overstrain.
4. Before each usage please check if the connection between the jointer of the water inlet hose and the water tap, and the installation of the water inlet hose are firm, so as to prevent dropping from improper installation position.

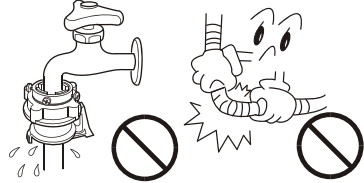

## Take down the water inlet hose

1. Close the water tap.
2. Press the locking lever. Push down the slider. Then pull off the water inlet hose. If the machine is used more than once every week, the jointer of the water inlet hose can be kept on the tap to prevent damaging the fixing screw.

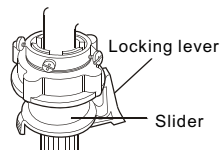

# Preparation before washing







## Preparation before washing

1. Connect the water inlet hose and open the water tap .
2. Confirm that the washing machine is earthed reliably . Then insert the power plug into the receptacle. Do not connect the earth terminal to the gas pipe and tap water pipe.
3. Put down the drain hose.



4. Slanting or uneven ground may result in unstable working or abnormal noise. Please make the machine stand horizontally.

## Pay attention to followings before washing the laundries

<p>Confirm if there's special requirement for the laundries.</p>	<p>Clear the pocket. Take out the coins , sand, hairpins etc.</p> 	<p>Fasten the buttons and zippers.</p> 	<p>The quantity of the laundries shall not exceed the rated value. The big laundries like the jeans shall be put in loosely.</p> 	<p>When the pulsator is running , the buttons of the laundries may cause noise. For the sake of discretion, please put the laundries with buttons into other laundries.</p> 
------------------------------------------------------------------	-------------------------------------------------------------------------------------------------------------------------------------------------------	----------------------------------------------------------------------------------------------------------------------------	----------------------------------------------------------------------------------------------------------------------------------------------------------------------------------------------------------------------	-----------------------------------------------------------------------------------------------------------------------------------------------------------------------------------------------------------------------------------------------------------------

- A. Please check if the laundries are applicable for washing.
- b. Separate those not colorfast from other laundries.
- C. For laundries not water absorbing, please put them into water with hands.
- D. For laundries with much soil, please remove the soil first. You can add detergent on the part with serious soil directly. It is much easier to remove the soil by that mean.
- E. For laundries likely to get lint ball or with long fiber, please first turn the inside out before putting them into the water.
- f. Do not put the laundries polluted with chemicals directly into the washing machine.
- g. For those small laundries ,laundries likely to be twisted or worn, and woolen laundries, please put them into mesh bag before washing.

# Put in the laundries



- The capacity of washing and spinning of the machine refer to the largest weight of the standard laundries under dry condition that can be washed or spun in one time. One time washing quantity shall be lower than the rated capacity.
- The thickness, size, type of the cloth will influence the actual washing capacity. It is suitable for one time washing to put in reasonable amount of laundries and the laundries can be turned round in washing.
- Do not select "High" water level for laundries small than 1.0kg, so as to avoid splashing of water.

## Usage of the detergent

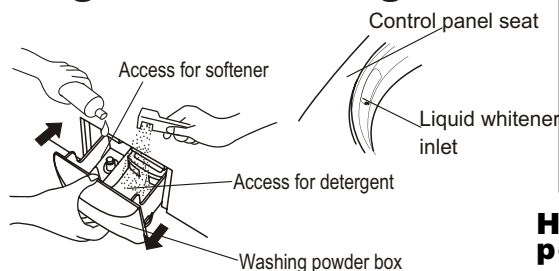

- Put the washing powder and softener into the detergent box directly as indicated in the left figure.
- After that, please close the detergent box. Refer to the following table for the usage of the detergent: The standard dosage of the detergent and the water quantity

### How to use the softener

- See to the manual of softener for the usage and dosage.
- When adding softener into softener inlet of washing powder box, not that it shall not exceed the lower side of the water cap.
- Do not leave the softener for long period after adding it into the box. Otherwise it may be solidified and block the inlet.
- As the softener is easy to solidify, please clean the box frequently. (You shall clean each time you use reserve function.)

### How to use the whitener

- Fill water to decided level. Dilute the whitener with container. Pour it slowly into the washing tub.
- Avoid using whitener on laundries with color or pattern as they are prone to lose color.
- The whitener shall not touch the laundries directly.
- Refer to the user's manual for the usage and quantity of the whitener.
- For powder whitener, please dissolve it before use.

### How to use the washing powder

- If you use fuzzy program and reserve washing please first put the washing powder into the washing powder box.
- Direct dissolved in the machine (Not applicable for fuzzy program and reserve washing)
  1. Fill water to "Low" water level.
  2. Add the power. Run for 30 seconds to dissolve it completely.
  3. Put in the laundries. Select suitable water level.
- The instant dissolving of the washing powder:
  1. Prepare warm water of 30°C and a container.
  2. Add the powder while stirring to fully dissolve it.
- Put in the proper quantities detergent according to the water level and the laundries quantities.
- The super quick program, it is suggested to adopt liquid detergent instead of washing powder to guarantee the washing effect.
- It is suggested not to use high sudsing detergent.
- Washing powder with poor quality or long time storage maybe caked. Please pay attention to cleaning the detergent box in time

# Use the operation buttons

## a Description of the function of the buttons

### Mode and meaning of the indicator

- 
- : Flash : indicating the running mode
- On: indicating the mode about to run

### "POWER ON/OFF" button

- Push the "POWER ON/OFF" button to switch on the power.
- When the power is on, push it again to switch off the power.
- Push the "POWER ON/OFF" button to switch on the power.  
If the start/pause button is not pushed, the washing machine will automatically switch off the power after 5 minutes.

### "Program" button

The following five programs are available for your option

P R O G R A M	Standard	Common washing
	Heavy	Washing the heavy clothes
	Gentle	Washing the woolen textiles or underwear
	Fast	10-minute quick washing of laundries with light soil
	Jeans	Washing the relatively big and thick laundries

### "RESERVE" remain time indicator digitron

- During sensing, it displays "—"
- During reserve procedure, it displays the remained reserve time (in hours)
- During operation of programs, it displays the remained time (minutes).
- In case of abnormal phenomenon, it displays the abnormal symbol (see to Page 15)

Page 15

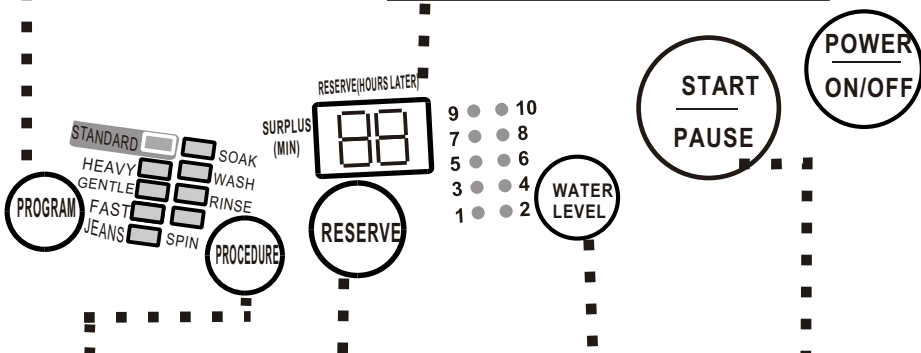

### "Procedure" button

- Push it to select one or more programs from SOAK WASH RINSE and SPIN

### "Reserve" button

- Push the button to select washing finishing time between 2-24 hours.
- When the RESERVE function is activated, the digitron of TIME REMAIN is flash. The other indicators are off. Push the RESERVE button to display the reserve mode.

### "Water level" button

- The washing machine can detect the laundries automatically. After detection, it will set the water level to suitable value among 4, 6, 8, and 10 automatically.
- You can also set water level by self. After the machine is started, it will not set water level automatically. You shall push the START/PAUSE button to make new setting.
- If wet laundries are put in, it may display water level 10. You must set suitable water level by yourself.
- If quick program is selected, the water level will be set to 2 automatically. And you cannot change the water level by yourself.
- During operation of wash and rinse program, you can push down the water level button to add water. When you release the button, or it reaches the overflow water level, the machine will stop adding water. The water level decided may be different from actual value because of the different moisture level of the laundries.

### "Start/Pause" button

After the power is switched on, push it to Start the machine

- During working, push it to pause working.
- During pause, push it to resume working.

## b Steps of using the operation buttons and description of the steps

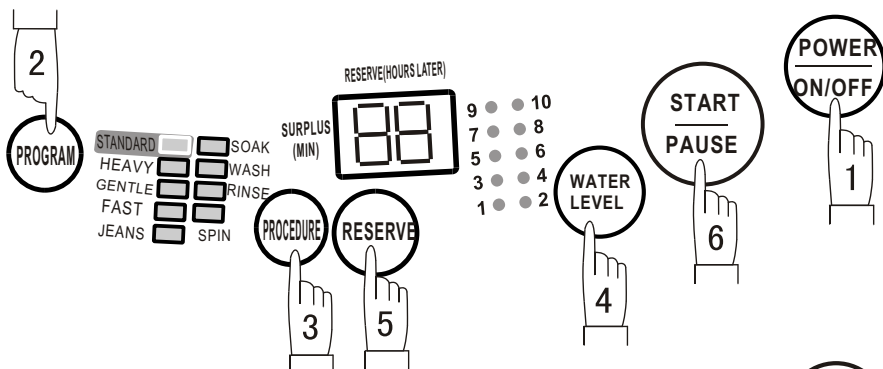

### 1 Push the "POWER ON/OFF " button to switch on the power.

- It has the special power resume function. In the case of power failure or the power plug is loose during washing, the machine can save the running program, and resume the program after the power supply is recovered. You do not need to set the program again.

### 2 Push the "PROGRAM" button to select suitable automatic program.

After switching on the power, the machine will set standard program automatically. To select other automatic program, push the "program" button till the relative indicator is on. Refer to the "program button" on Page 10 for the selection.

For instance: select "FAST" program for laundries with small quantity and light soil.

Page 10

- In selecting the standard program, the machine will execute fuzzy program to select water level and wash time according to the cloth and weight of the laundries. The full procedure is controlled automatically.

### 3 Push the "PROCEDURE" button to select suitable procedure.

After switching on the power, the washing machine will set wash-rinse-spin procedure automatically. it is the standard procedure. to select other procedures, push the procedure button to select one or more procedures from soak, wash, rinse and spin. Refer to the "PROCEDURE SELECTION METHOD " on Page 12 for the selection.

Page 12

## Attention

- Even there's no water in the tub, a certain period is required before spin starting.
- Do not use the soak program for the woolen textiles.
- Separate the laundries that are not colorfast from other laundries in washing.
- The pulsator will not rotate unless the water is filled to selected water level.

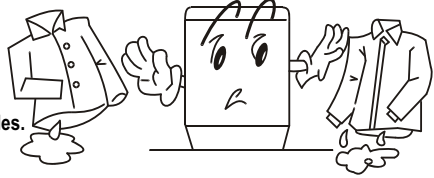

## Procedure selection method

Times of pushing the PROCEDURE button	Selected procedure	Applicable circumstance	Contents (the lighted indicators indicate the programs about to run)
0	WASH - RINSE-SPIN (STANDARD procedure)	When the common laundries need washing, rinsing and spinning.	SOAK ● WASH ○ RINSE ○ SPIN ○
1	WASH (the washing liquid remains in the tub)	Repeat using the washing liquid	SOAK ● WASH ○ RINSE ● SPIN ●
2	WASH - RINSE (the rinsing liquid remains in the tub)	When prevent the laundries from corrugating, and the laundries do not need spinning	SOAK ● WASH ○ RINSE ○ SPIN ●
3	RINSE - SPIN	When the laundries need only rinsing, spinning after manual washing	SOAK ● WASH ● RINSE ○ SPIN ○
4	SPIN (spin after drain)	When the laundries need only spinning after manual washing (first drain then spin)	SOAK ● WASH ● RINSE ● SPIN ○
5	SOAK - WASH- RINSE-SPIN	The laundries are very dirty, or the sleeves and collars of the shirt are very dirty. First soak then wash.	SOAK ○ WASH ○ RINSE ○ SPIN ○

- Push the PROCEDURE button for 6 times, and it will resume the initial mode. It will circulate in that sequence.
- The SOAK procedure can work in cooperation with automatic programs like standard, jeans and heavy. There is intermittent pulsator stirring during soak.

### 4 Press " WATER LEVEL "button, select suitable water level



After switching on the power, the washing machine will execute fuzzy program automatically to detect the cloth. After defection, it can set the water level automatically. To select other water level, first push the "start/pause" button, then push the "water level" button to set the water level, to select a suitable water level depending on the load. Refer to the "water level button" on Page 10 for the selection.

## ●● Push the "reserve" button to select suitable reserve wash program



After switching on the power, the reserve program is set to off mode automatically. If you need to set the washing procedure to be finished at reserved time, please push the " reserve " button to set the reserve wash program. Refer to reserve button in Page 10 for selection.

- Confirm the operation of reserve program



- When the RESERVE function is activated, the digitron of TIME REMAIN is flash. The other indicators are off. Push the RESERVE button to display the reserve mode.
- To change the running program or cancel the reserve setting, you need to switch off the power and make new selection.



the washing will be finished after 18 hours.

## 6 Push the "start/Pause" button

## Close the lid

Except water filling ,washing,rinsing and draining, if the top cover is opened, the washing machine will stop running and alarm.

## Finish washing

After finishing wash , it'll switch off the power automatically.

## Disposal after washing

- After using, please clean the lint and foreign materials of the lint filter etc. in time. Otherwise it may influence your using the machine.
- Please first pull off the power plug from the receptacle before cleaning.

Clean the detergent box and set it on the control panel seat.

- 1 The method of dismantle : Push it up aslant and gently.
- 2 The method of install : install it upwards and aslant and push it in .

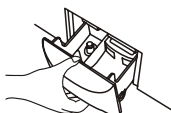

Dismantle



Install

- The lint filter must be used during washing.
  - It must be cleaned in time after each using
- Lint filter:

1. Rotate the inner tub with hand till the lint filter reaches the position convenient for you to take it off. Pull it up to dismantle.
2. Push it down to install.
3. Clean the filter screen after washing.



Dismantle Install

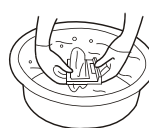

Clean

Dismantle and Install

The filter screen of the water inlet valve is likely to be blocked by foreign materials and influence the water inlet. Please clean it with brush every two months.



If the cabinet is dirty, wipe it with wet cloth

- Do not flush it directly with water.
- Wipe it with neutral detergent.
- Do not wipe it with thinner, petrol, alcohol etc.



1. After washing, close the water faucet. ( If needed, you can dismantle the water inlet hose).
2. Do not store water in the washing machine for a long period. Drain the water completely after each using.
3. Be sure to pull off the power plug before maintenance.
4. Hang up the power cord and drain hose.
5. Wipe off the water drops on the surface of the machine and inside the tub. Open the top lid for some time (about 1 hour), then close the top lid.



# Trouble-shooting Answer to question





(If there's breakdown, please pull off the power plug before checking) The following phenomena are not breakdowns sometimes. Please confirm again before sending it to repair. If there are real breakdowns, please come to the special maintenance department or after-sale service department of our company. Do not repair it by yourself.

Phenomena		The reason	How to settle
The digitron displays E0.		<ul style="list-style-type: none"> <li>● The top lid is opened during reserve procedure.</li> </ul>	<ul style="list-style-type: none"> <li>● Close the top lid.</li> </ul>
The drainage cannot work, or is too slow. The digitron displays E1.		<ul style="list-style-type: none"> <li>● Is the drain hose put down?</li> <li>● Is the drain hose blocked?</li> </ul>	<ul style="list-style-type: none"> <li>● Put down the drain hose. Open and close the top lid once.</li> <li>● Clean the foreign material. Open and close The top Lid Once.</li> </ul>
Running pauses during spin, nixie tube indicates "E2", buzzing		<ul style="list-style-type: none"> <li>● The top lid is not closed.</li> </ul>	<ul style="list-style-type: none"> <li>● Close the top lid.</li> </ul>
The safety switch acts, and the spinning cannot work. The digitron displays E3.		<ul style="list-style-type: none"> <li>● Are the laundries put slantingly?</li> <li>● Is the machine slanting?</li> </ul>	<ul style="list-style-type: none"> <li>● Reorder the laundries. Close the top lid.</li> <li>● Set the washing machine horizontally and then open and close the top lid once.</li> </ul>
The water filling does not work, or is slow. After about 40 minutes later, the digital displays E4.		<ul style="list-style-type: none"> <li>● Is the water tap opened, or is there water supply failure?</li> <li>● Is the water inlet valve blocked?</li> <li>● Is the water pressure too low?</li> </ul>	<ul style="list-style-type: none"> <li>● Open the water tap. Open and close the top lid once.</li> <li>● Clean the water inlet valve then open and close the top lid once.</li> <li>● Open and close the top lid once.</li> </ul>
The digitron displays E6.		<ul style="list-style-type: none"> <li>● The water level sensor is bad.</li> </ul>	<ul style="list-style-type: none"> <li>● Please contact the after-sales service department.</li> </ul>
The machine does not act	Not wash	<ul style="list-style-type: none"> <li>● Is there power failure?</li> <li>● Is the power plug inserted tightly?</li> <li>● Is the water level reached preset position?</li> </ul>	<ul style="list-style-type: none"> <li>● Please use it when there's power supply.</li> <li>● Insert the power plug tightly.</li> <li>● Fill water to the preset position.</li> </ul>
	Not spin	<ul style="list-style-type: none"> <li>● Is the power plug inserted tightly?</li> <li>● Is the top lid closed reliably?</li> <li>● Are the laundries set flat?</li> </ul>	<ul style="list-style-type: none"> <li>● Insert the power plug tightly.</li> <li>● Close the top lid.</li> <li>● Set the laundries flat.</li> </ul>
There's abnormal sound inside the machine		<ul style="list-style-type: none"> <li>● Is the machine slanting?</li> <li>● Are the laundries put slantingly in spinning?</li> <li>● Are there any foreign materials?</li> </ul>	<ul style="list-style-type: none"> <li>● Adjust the machine to be even</li> <li>● Reorder the laundries and close the top lid.</li> <li>● Remove the foreign materials.</li> </ul>
The water tap leaks		<ul style="list-style-type: none"> <li>● Is the screw of the jointer of water inlet hose loose or awry?</li> </ul>	<ul style="list-style-type: none"> <li>● Fasten the screw of the jointer properly.</li> </ul>

## Common phenomena

Phenomena	Explanation
<ul style="list-style-type: none"> <li>● The spinning is intermittent when it starts.</li> </ul>	<ul style="list-style-type: none"> <li>● Balance the laundries to avoid slanting.</li> </ul>
<ul style="list-style-type: none"> <li>● The wash procedure pauses.</li> </ul>	<ul style="list-style-type: none"> <li>● The cloth sensor is detecting, it will add water after about 48 seconds</li> </ul>
<ul style="list-style-type: none"> <li>● Select spin program, but it does not work.</li> </ul>	<ul style="list-style-type: none"> <li>● The program is setting the drain time, certain period is needed before it starts spinning.</li> </ul>
<ul style="list-style-type: none"> <li>● The pulsator pauses during water filling in washing and rinsing.</li> </ul>	<ul style="list-style-type: none"> <li>● It is to avoid splashing during water filling.</li> </ul>
<ul style="list-style-type: none"> <li>● There may be some water flowing out of the drain hose in the first use of the machine.</li> </ul>	<ul style="list-style-type: none"> <li>● It is the water remained performance inspection by the factory.</li> </ul>
<ul style="list-style-type: none"> <li>● When the power plug is inserted, computer board indicator is switched on, and the machine starts working</li> </ul>	<ul style="list-style-type: none"> <li>● It is the special resume function. In the case of power failure or the power plug is loose during washing, the machine can save the running program, and resume the program after the power supply is recovered. You do not need to set the program again</li> </ul>

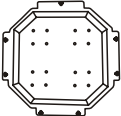
# Packing list

Name	Quantity
● User's manual	● One
● Guarantee	● One
● Components of the water inlet hose 	● One
● Lint filter 	● One
● Bottom plate 	● One
● Tapping screws 	● Seven
● Full automatic washing machine	● One