

# PP945SM

## GE Profile™ Series 30" Built-In CleanDesign Electric Cooktop

### Dimensions and Installation Information (in inches)

KW Rating	
240V	7.8
208V	5.9
Breaker Size	
240V	40 Amps†
208V	30 Amps†

†**Note:** Check local codes for required breaker size

**Important:** Requires a 5" free area between the bottom of the cooktop to any combustible material, i.e., shelving. Free area not required when installing wall oven underneath cooktop. Refer to installation instructions. Requires a 15" minimum from cooktop to adjacent overhead cabinets. Units are furnished with a 48" flexible armored cable.

**Note:** 30" Ribbon cooktops are approved for use over select GE 30" Single Wall Ovens and Warming Drawers. All 30" ribbon cooktops can be installed over 27" wall ovens and warming drawers. Refer to cooktop and wall oven/warming drawer installation instructions packed with product for current dimensional data. If installed with a GE Profile™ Telescopic Downdraft System, consult both the cooktop and downdraft installation instructions packed with product before installing. Cooktop gas/electric supply may need to be re-routed to install downdraft. The countertop must be at least 26" deep with a flat surface area of 23-1/2" or more, front to back. In addition, other clearances to the front edge of the countertop must be considered. Consult cabinet and countertop manufacturer's specs for flush mount installation prior to install. **Before installing, consult installation instructions packed with product for current dimensional data.**

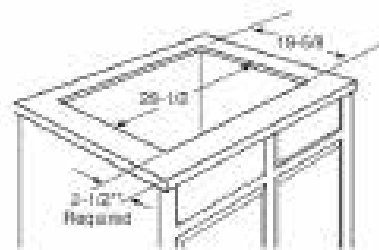
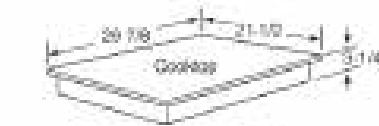

\*Depth of unit at conduit connection location (rear) is 5-1/4" on models PP875/945 and 4-3/16" on models CP555/650, PP944/952/952/912, and JP555/646. Depth of unit at back (front) is 4-5/8" on models PP945/900.

\*Flush mount on some countertops may require up to 3/8" additional clearance to prevent interference with curved front.

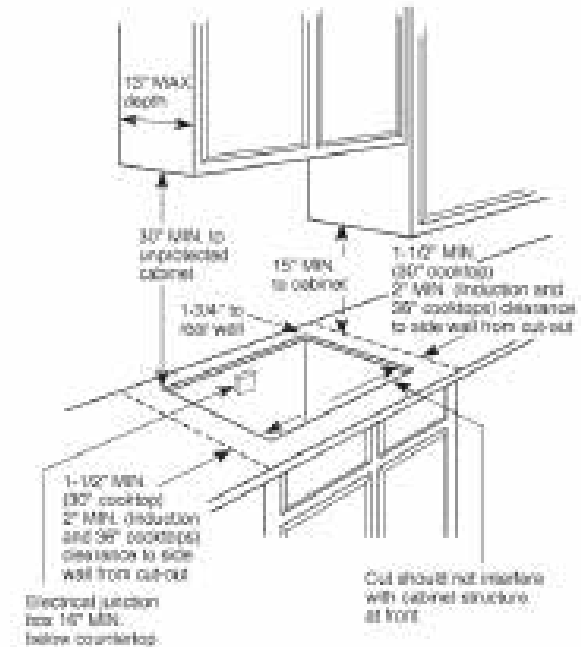

imagination at work

For answers to your Monogram® or GE® appliance questions, visit our website at [geappliances.com](http://geappliances.com) or call GE Answer Center® service, 800.626.2000.



Listed by Underwriters Laboratories

# PP945SM

## GE Profile™ Series 30" Built-In CleanDesign Electric Cooktop

### Features and Benefits

- Electronic Touch Controls - Offer easy, point-and-cook convenience
- Ribbon Heating Elements - Provide powerful heat beneath a smooth glass surface to ensure even heat and fast warm-up times
- 12"/9"/6" Tri-Ring Element - Accomodates various-sized pots or pans for the ultimate in cooking versatility
- Power Boil Element - Provides up to 3,000 watts of power to speed the boiling process
- Stainless Steel Frame - Brings an added touch of style to any decor and perfectly complements all other stainless steel appliances in the kitchen
- Control Lock Capability - Provides the ability to lock controls, helping protect from unintentional activation
- Model PP945SMSS - Stainless steel

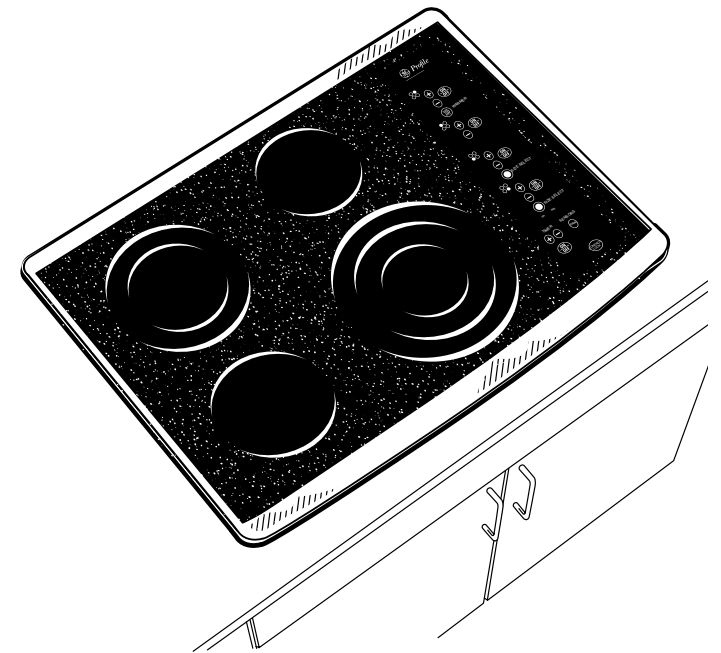

imagination at work