

# SeaLand® MACERATOR TOILET OWNER'S MANUAL

## SeaLand® 8800 Series All-Ceramic Toilets

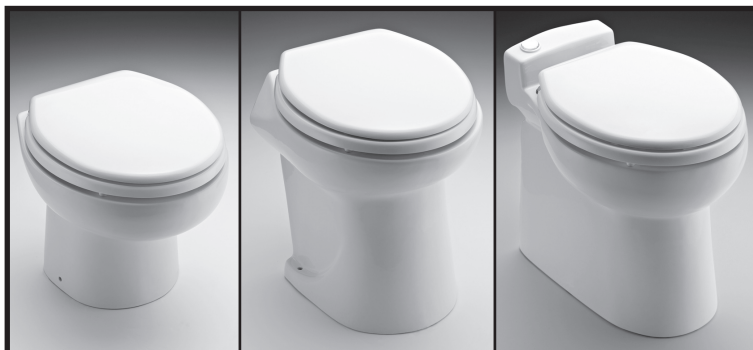

**8812**

**8818**

**8819**

# TABLE OF CONTENTS

..... 1	..... 13
..... 2	Extended Periods of Non-use..... 14
..... 2	..... 14
..... 3	..... 15
Warnings ..... 3	..... 16
..... 4	..... 17-18
..... 5-7	Accessories and Kits ..... 19
..... 8-12	..... 20

# TOILET SPECIFICATIONS

Model	Description	Weight	Color	Voltage	Item Number
8812		38.6 lbs. (17.5 Kg)	Bone	12 VDC	304881211
				24 VDC	304881221
				12 VDC	304881213
				24 VDC	304881223
8818		46.3 lbs. (21 Kg)	Bone	12 VDC	304881811
				24 VDC	304881821
				12 VDC	304881813
				24 VDC	304881823
8819	bowl.	56 lbs. (25.4 Kg)	Bone	12 VDC	304881911
				24 VDC	304881921
				12 VDC	304881913
				24 VDC	304881923

## DIMENSIONS

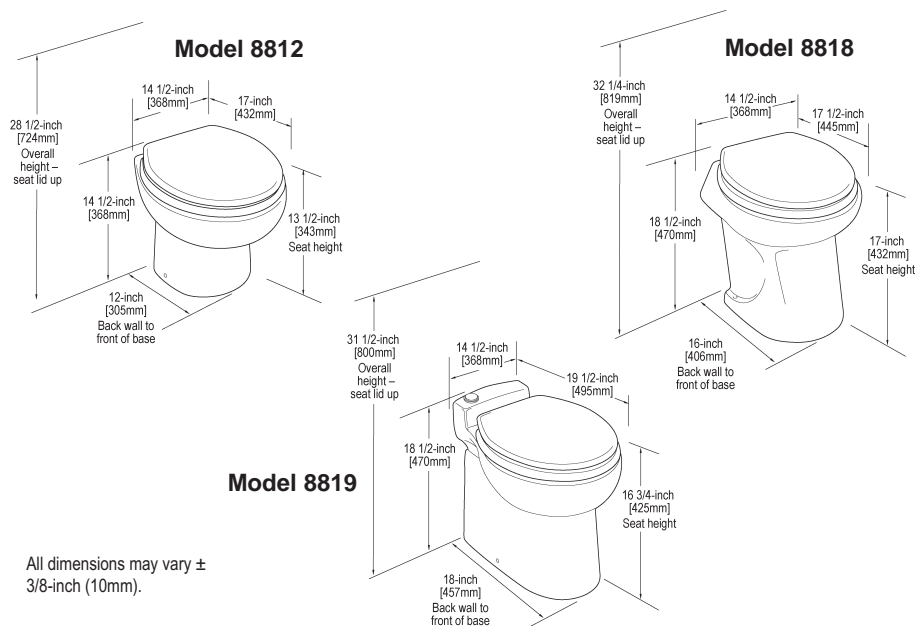

---

## TOILET MODEL IDENTIFICATION

---



---

## WARNINGS

---

The following cautionary statements must be read and understood before installing, servicing and/or operating this product. Modification of this product may result in property damage.

installation. DOMETIC SANITATION CORPORATION ACCEPTS NO RESPONSIBILITY OR LIABILITY FOR DAMAGE TO EQUIPMENT, OR INJURY OR DEATH TO PERSONNEL THAT MAY RESULT FROM IMPROPER INSTALLATION, SERVICE OR OPERATION OF THIS PRODUCT.



**WARNING!**  
**HAZARD OF FLOODING**



**WARNING!**  
**HAZARD OF FLOODING**



**WARNING!**  
**HAZARD OF FLOODING**

and life.



**WARNING!**  
**HAZARD OF FLOODING**

*\* if connected to raw water*



**WARNING!**  
**HAZARD OF FLOODING**



**WARNING!**  
**HAZARD OF FLOODING**



**WARNING!**  
**HAZARD OF FLOODING**



**WARNING!**  
**HAZARD OF SHOCK OR FIRE**



**CAUTION**

**TOIPET START**

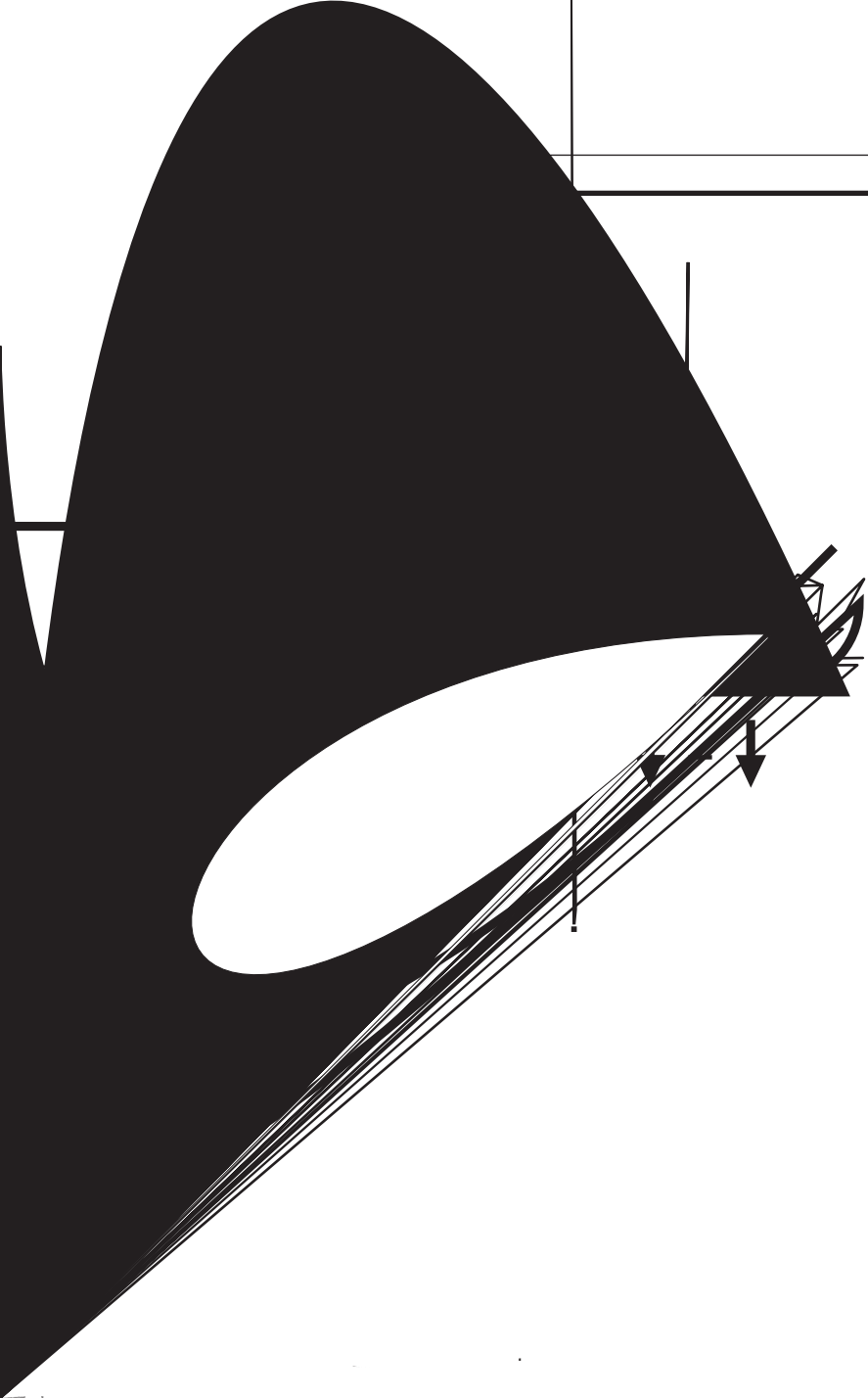

# INSTALLATION – SYSTEM DIAGRAMS

## FLUSH WATER OPTIONS

- 
- during NORMAL and LOW

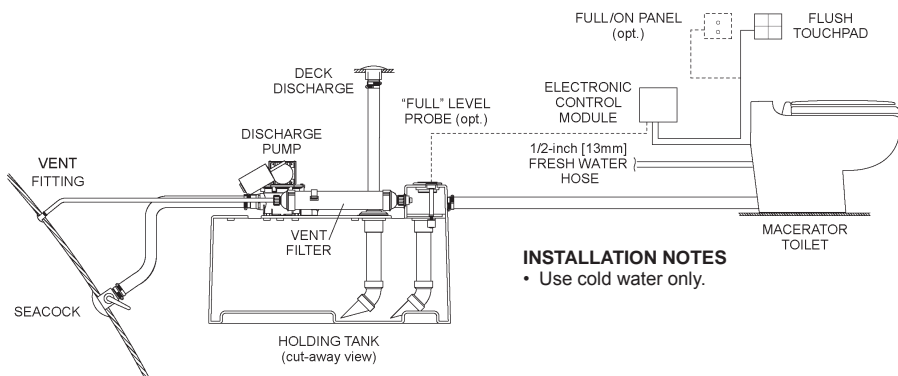

**WARNING!**  

**HAZARD OF FLOODING** – If toilet uses raw water for flushing at ANY time, a raw water pump controlled by an automatically operating demand switch **MUST NOT** be installed. If the onboard water valve or any plumbing connections were to leak, the automatically operated pump would start and could flood the boat. Failure to comply with this warning can cause loss of property and life. See other WARNINGS (p. 3).

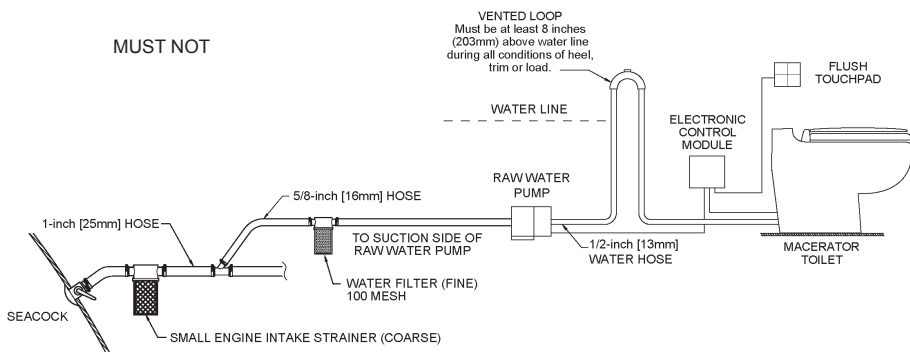
## INSTALLATION NOTES

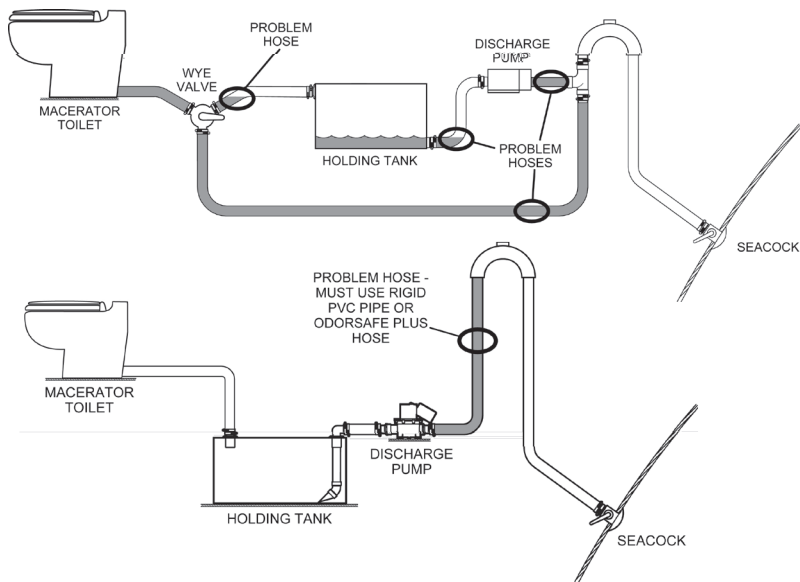

# INSTALLATION – SYSTEM DIAGRAMS (cont'd)

## DISCHARGE PIPING



NOTE

## VENTED LOOPS



### WARNING!

**HAZARD OF FLOODING** – If toilet rim is below the waterline at ANY time (during any conditions of heel, load or trim) and is connected to ANY through-the-hull fittings, properly positioned ventilated (vented) loops MUST be installed in intake\* or discharge piping to prevent potential back siphonage of seawater into the boat. Failure to do so can result in flooding which can cause loss of property and life.

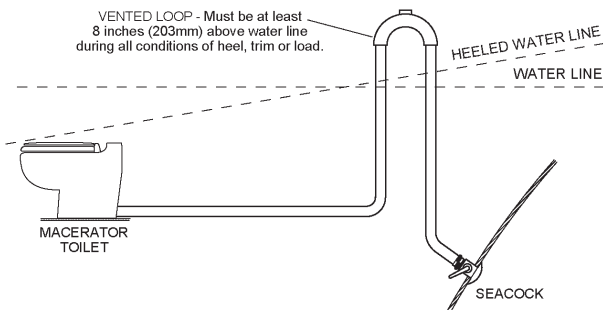

\* if connected to raw water

---

## INSTALLATION – SYSTEM DIAGRAMS (cont'd)

---

### HOLDING TANKS

### SEACOCKS



**CAUTION:** Overfilling the holding tank can create serious damage to the sanitation system, such as rupturing the holding tank and releasing tank contents into the bilge. To prevent this possibility, Dometic strongly recommends the addition of a “Full” tank safety shut-down relay to the toilet’s electronic control module (a pre-wired base is provided for this relay inside the box). The “Full” signal from the holding tank can be generated by any SeaLand TankWatch level monitor system.



#### **WARNING!**

**HAZARD OF FLOODING** – If the toilet is connected to ANY through-the-hull fittings, properly installed seacocks **MUST** be installed in all piping connected to through-the-hull fittings. Seacocks **MUST** be easily accessible to all users of the toilet or secondary valves fitted in hoses where they are easily accessible. All valves **MUST** be full bore valves and of marine quality. Screw-to-close gate valves are not recommended. Failure to do so can result in flooding which can cause loss of property and life.

---

### **RISER STEP OR PLINTH INSTALLATIONS (SEAT HEIGHT)**

Toilet Model	Seating Height
8812	
8818	
8819	

# INSTALLATION – TOILET COMPONENTS

## MAJOR TOILET SYSTEM COMPONENTS

erator Toilet  
Control Module

SeaLand Mac-  
Electronic

Flush Control Touchpad

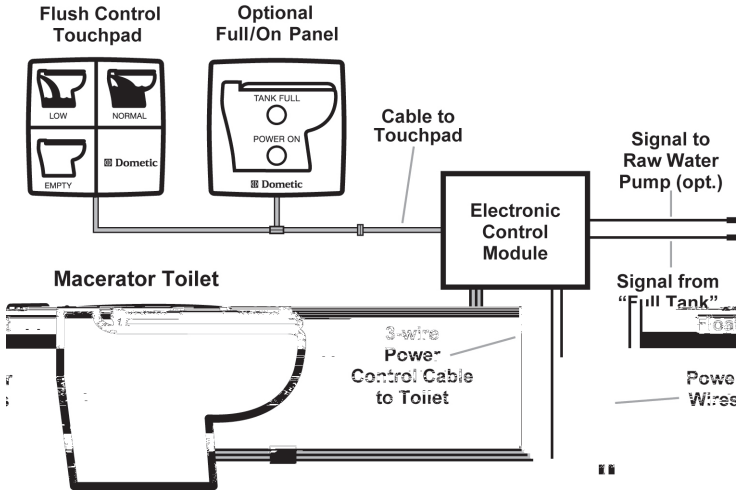

## WIRING / ELECTRONIC CONTROL MODULE CONNECTIONS



**WARNING!**

**HAZARD OF SHOCK OR FIRE –**  
Always use recommended fuse, circuit breaker and wire size. Failure to do so can result in fire that can cause the loss of property and life.

### IMPORTANT INSTALLATION NOTES

### WIRE SIZING CHART

Wire size per length of run*	0-50 ft.	51-100 ft.	100-150 ft.	–
	#12	#10	#8	
	0-30 ft.	31-100 ft.	101-175 ft.	176-250 ft.
	#14	#12	#10	#8

### CONVERSION TABLE

Wire – AWG to mm <sup>2</sup>					Feet to Meters								
AWG	14	12	10	8	Ft.	10	15	20	30	50	75	100	150
mm <sup>2</sup>	2.5	4.0	6.0	10.0	M	3.0	4.6	6.1	9.2	15.2	22.9	30.5	45.7



# INSTALLATION – TOILET COMPONENTS (cont'd)

## WIRING SCHEMATIC

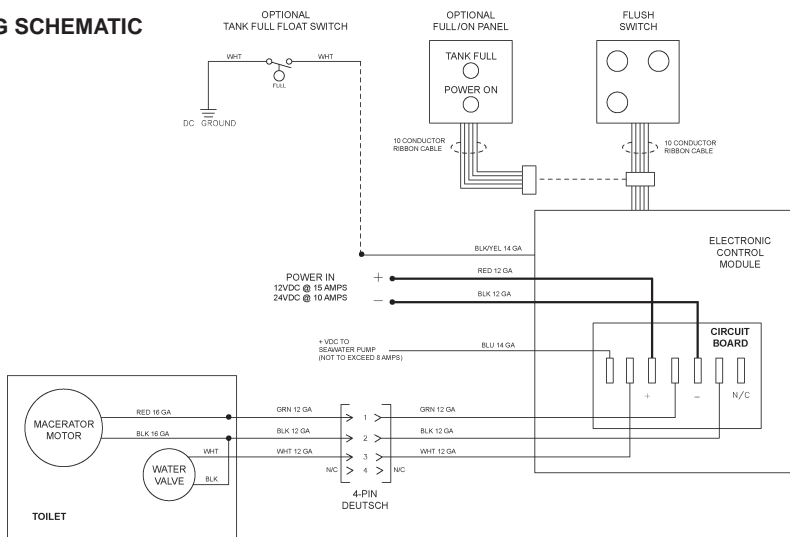

## SYSTEM COMPONENTS (included with toilet)

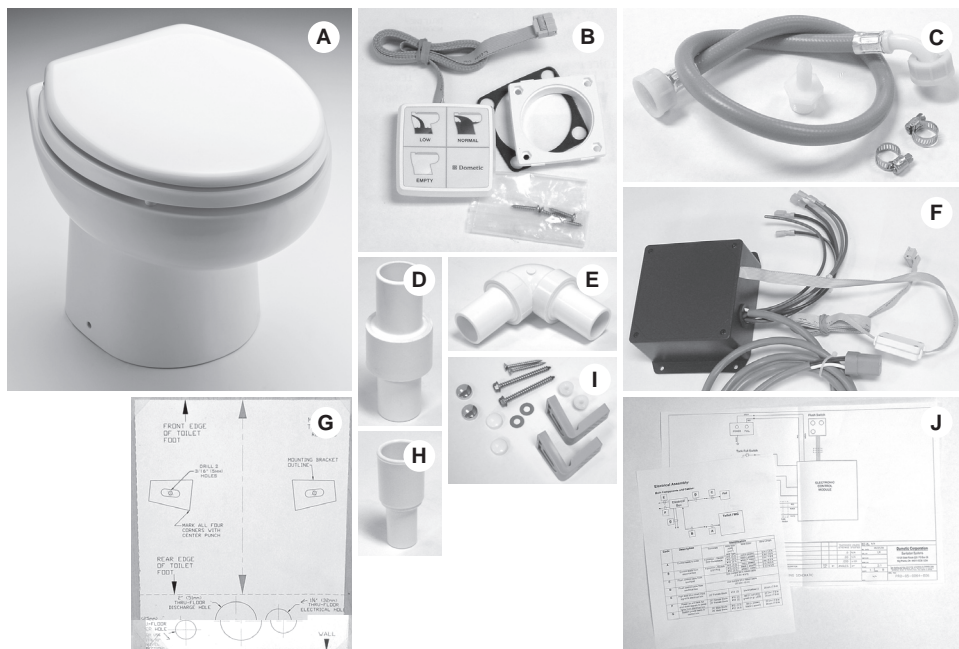

A. Toilet

F. Electronic Control Module

# INSTALLATION – TOILET COMPONENTS (cont'd)

## TOOLS REQUIRED

### THROUGH-THE-FLOOR CONNECTIONS

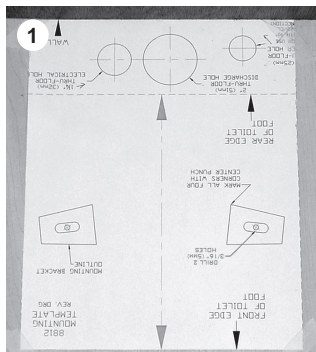

Place template in desired location.

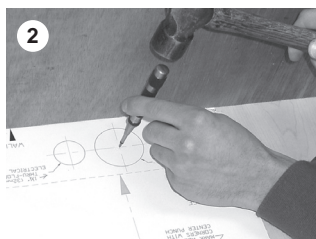

Center-punch holes and mounting bracket corners.

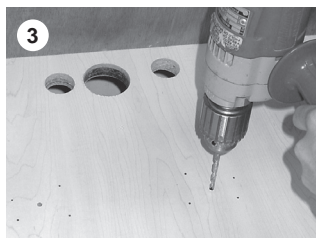

Drill hole centers as shown on template. Do not drill mounting bracket corners.

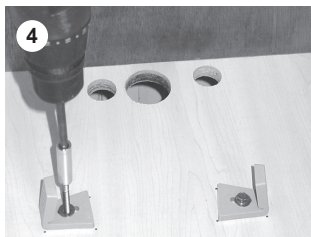

With long hex-head screws from toilet floor bracket kit, fasten floor brackets with 3/8" (10 mm) socket wrench using corner marks as guides.

**NOTE:** Do not completely tighten hex-head screws to floor – let brackets move freely. Brackets will tighten when mounting toilet to brackets (see step 15, next page).

Plan locations of touchpad panel and electronic control module and optional accessories so that all electrical connections can be made. Refer to Electrical Assembly drawing for supplied wire lengths.



Drill 2.25" (57 mm) hole for touchpad panel.

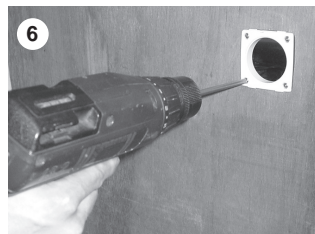

Fasten touchpad bracket and gasket to wall, making sure mounting tabs are at top and bottom.

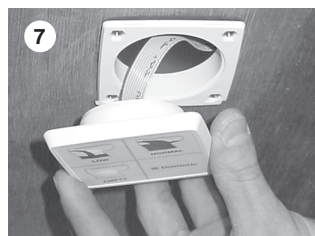

Route ribbon cable into wall and snap touchpad panel onto bracket mounting tabs.



Mount electronic control module in cool, dry place.

## INSTALLATION – TOILET COMPONENTS (cont'd)

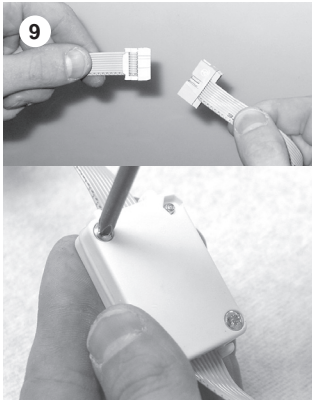

9  
Connect ribbon cables from touchpad panel and control module, and secure with water-proof connection enclosure.

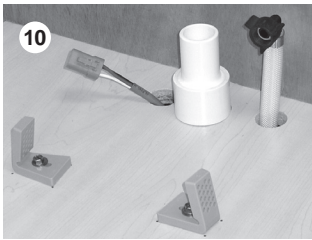

10  
Route power control cable from control module to toilet. Route water supply and discharge plumbing to toilet according to system requirements (see front cover of manual).

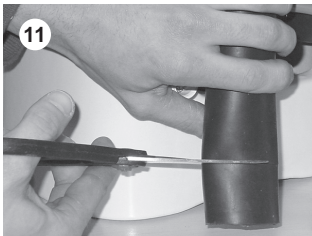

11  
Cut discharge hose from toilet to accommodate discharge connection.



12  
Place toilet into position, making sure to see the floor brackets through holes at bottom of toilet. Clamp discharge hose from toilet to discharge fitting.

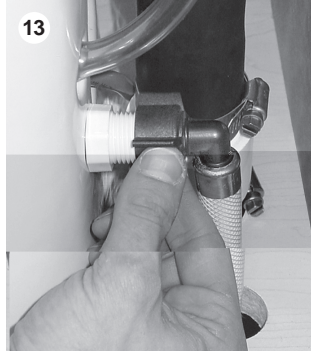

13  
Connect water supply to toilet inlet fitting.



14  
Connect power control cables from control module and toilet.

Complete power connections from circuit breaker to control module using proper electrical wire gauge and components. Complete plumbing system with proper supply and discharge components. Turn on water supply and electrical power to toilet. Check for proper toilet operation by pressing the "Normal" flush button to allow water into bowl and through macerator. Repeat flushing cycle as many times as desired to assure proper operation and that no leaks exist in supply and discharge lines and connections.



15  
Insert plastic adapters from Toilet Floor Bracket Kit into holes at bottom of toilet. Fasten toilet to floor brackets with screws.



16  
Cover floor bracket screws with white or chrome covers.

---

## INSTALLATION – TOILET COMPONENTS (cont'd)

---

### THROUGH-THE-WALL CONNECTIONS



*To route wiring and plumbing connections through the wall, use floor template to locate vertical centerline of each hole, then put toilet in proper position and mark horizontal centerlines. Drill hole sizes as indicated on template. Route wiring and plumbing through holes, and then install toilet.*

---

### 8819 WATER LINE CONNECTION OPTIONS

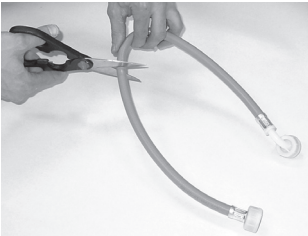

*Gray water line has both a 90-degree and straight connector at its ends. Select best connector for your installation, then measure and cut water line.*



*Connect elbow fitting to water valve for through-the-wall connection.*



*Connect straight fitting to water valve for through-the-floor connection.*

---

## PROPER BOWL CLEANING

---

For stubborn bowl stains, use SeaLand® Toilet Bowl



toilet bowl cleaner, etc.). Please follow label instructions.

**To avoid damaging the internal seals,**

**DO NOT USE:**

- abrasives (Comet®, Soft Scrub® cleansers etc.)
- caustic chemicals (Drano® clog remover, etc.)
- lubricants and cleaners containing alcohols or petroleum distillates (Pam® cooking spray, Pine-Sol® cleaner, WD-40® lubricant, etc.).

Laboratories Inc.

Inc.

national.

---

## ROUTINE TOILET MAINTENANCE

---

**MONTHLY:**

**YEARLY:**

---

## **EXTENDED PERIODS OF NON-USE – LAYING UP TOILET**

---

---

### **WINTERIZING**

---

**NOTE:**

**CAUTION:** Never use automotive-type antifreeze in freshwater systems.

**PRESSURIZED FRESH WATER SYSTEM**

**RAW WATER SYSTEM**

- two containers

container.

# TROUBLESHOOTING GUIDE

Problem	Possible Cause	Service Instructions
slowly or not at all.		
unusually loud noise or		
	d. Circuit board in Electronic Control	
	(25 PSI or less).	a. Install an in-line water b. Install an in-line water screen.



# DEODORANTS AND SPECIAL TISSUE

Liquid or Granulated.

Formaldehyde versus Non-Formaldehyde.

®

How Much Deodorant and How to Add It.

Why Not Use Household Toilet Paper in Your Toilet.

SeaLand Brand versus Other Brands.



**SeaLand®  
Rapid-Dissolving  
Toilet Tissue**

Part No. 379441204



**SeaLand®  
Cleaner**

Part No.  
379314016



**SeaLand®  
Clean 'n Green  
Bowl Cleaner/Tank  
Deodorant**

Part No. 379512602

















**SeaLand® Liquid  
Deodorant -  
Environment Friendly**













Part No.  
379114032



## REPLACEMENT PARTS

	Description	8812	8818	8819
		385880001		
		385880002		
		385880003	385880005	385880007
		385880004	385880006	385880008
	Motor - 12 VDC	385880009		
	Motor - 24 VDC	385880010		
		385880011		
		385880012		
			385880013	385880014
		385880015		
		385880016		
		385880017		
		385880018		
		385880021	NA	NA
		385880022	NA	NA
		385880023		
		385880024		
		NA	NA	385880029
		385880030		NA
		385880032		NA
		385880034		

## REPLACEMENT PARTS (cont'd)

	Description	8812	8818	8819
			385880035	
			385880036	
			385880039	
			385880040	
		385880041	385880042	385880043
		385880044		
			385880045	
			385880046	
			385880047	
			385880048	
			385880049	
	12 VDC		385880050	
	24 VDC		385880051	
			385880052	
			385880053	
	connection enclosure		385880054	

## ACCESSORIES and KITS

	Description	8812	8818	8819
	extension		385880055	
			307341113	
			385880056	
	12 VDC		385880057	
	24 VDC		385880058	
			313900101	
			313900100	
			313000312	
			385880059	
			385880060	

---

## CUSTOMER SERVICE

---

330-496-3211 International

330-496-3220 International

---

## MANUFACTURER'S TWO-YEAR LIMITED WARRANTY

---

### EXCLUSIONS

IN NO EVENT SHALL **DOMETIC** BE LIABLE FOR INCIDENTAL OR CONSEQUENTIAL DAMAGES, FOR DAMAGES RESULTING FROM IMPROPER INSTALLATION, OR FOR DAMAGES CAUSED BY NEGLIGENCE, ABUSE, ALTERATION, FOREIGN OBJECTS DEPOSITED IN THE TOILET, OR USE OF UNAUTHORIZED COMPONENTS. THIS INCLUDES FAILURES WHICH MAY RESULT FROM NOT FOLLOWING THE WINTERIZATION OR CLEANING PROCEDURES AS DESCRIBED IN THIS MANUAL. ALL IMPLIED WARRANTIES, INCLUDING ANY IMPLIED WARRANTY OF MERCHANTABILITY OR FITNESS FOR ANY PARTICULAR PURPOSE, ARE LIMITED TO A PERIOD OF TWO (2) YEARS FROM DATE OF PURCHASE.

### IMPLIED WARRANTIES

### OTHER RIGHTS

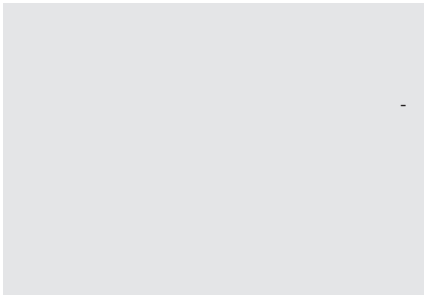

 **Dometic** *Sealand*

**Dometic Sanitation Corporation**  
13128 State Rt 226, PO Box 38  
Big Prairie, OH 44611